

100
Millimetres
0 10

Disclaimer:
Plans are based on asset management drawings and are not to scale.
All areas and dimensions are indicative and should be checked on site.

DO NOT SCALE

SAFETY, HEALTH AND ENVIRONMENTAL INFORMATION

In addition to the hazards/risks normally associated with the types of work detailed on this drawing, note the following:

CONSTRUCTION

MAINTENANCE/CLEANING

DECOMMISSIONING/DEMOLITION

It is assumed that all works will be carried out by a competent contractor working, where appropriate, to an approved method statement

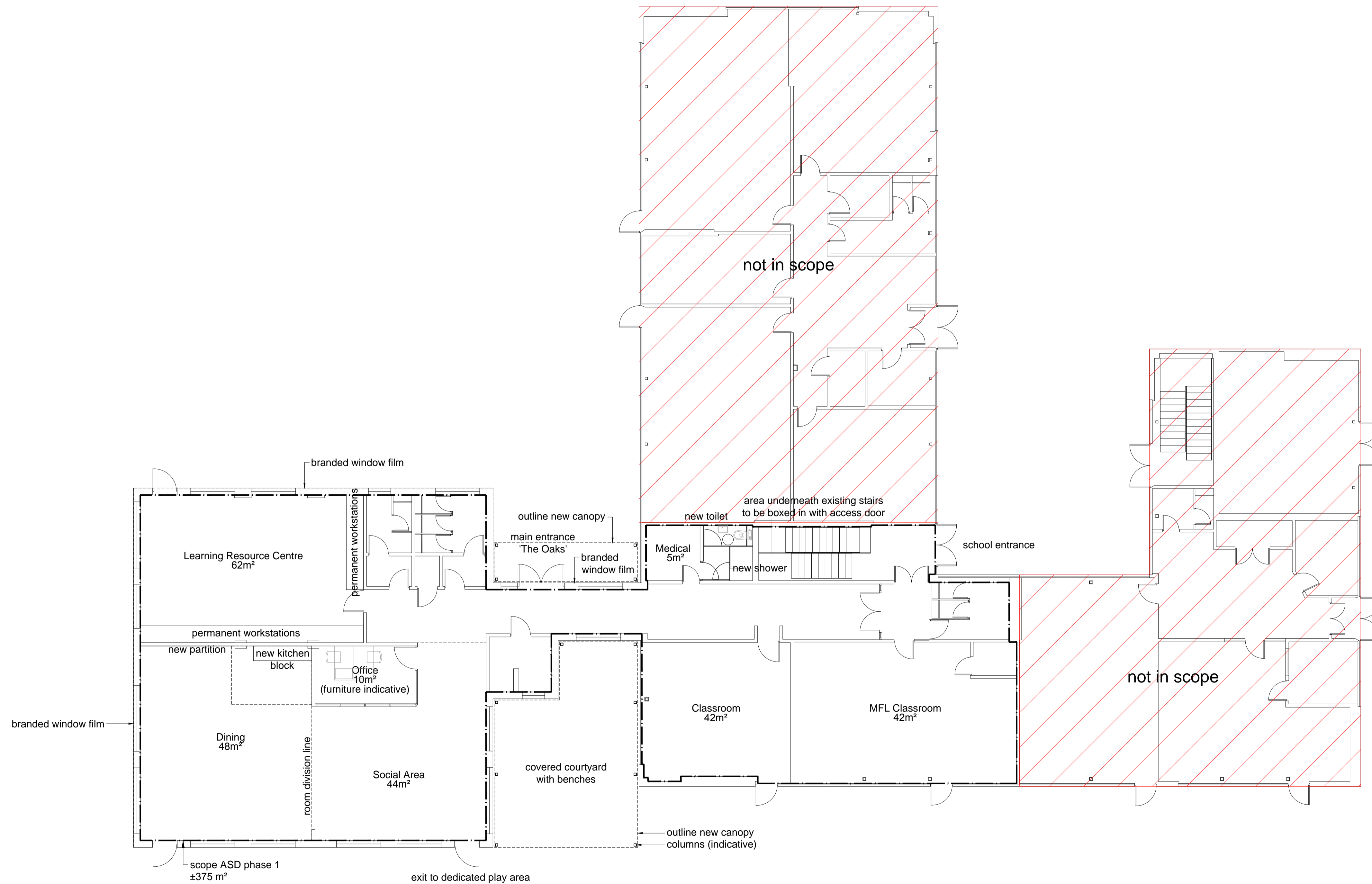

PROPOSED GROUND FLOOR (ASD PHASE 1)

Rev.	Date	Description	By	Chk'd	App'd
A1	28/16	First issue		MR	CW CW

Drawing Status: **PLANNING** Submittal: **P**

ATKINS Euston Tower
288 Euston Road
London
NW1 3AT
Tel: +44 (0)20 7121 2000
Fax: +44 (0)20 7121 2111
www.atkinsglobal.com

Copyright © Atkins Limited (2015)



Client: **St. Crispin's Comprehensive School**
Wokingham
Sixth Form Centre / ASD Unit

Drawing Title: **ASD Unit Plan**
Ground Floor (ASD Phase 1)
Proposed

Scale	Designed	Drawn	Checked	Authorised
1:100	MR	MR	CW	PW

Original Size	Date	Date	Date	Date
A1	10/11/2015	10/11/2015	13/11/2015	13/11/2015

Drawing Number: **5141836-ATK-00-DR-A-0112** Revision: **A 1**

