

Notes:

- Key:
- A - Rainscreen Cladding, manufacture: Trespa Miteon, multi white
 - B - Red brick, Manufacturer TBC
 - C - Powder coated Aluminium windows - exact RAL to be confirmed
 - D - First Floor Powder coated Aluminium windows with fritted glass
 - E - RWP aluminium, RAL to be confirmed
 - F - Building signature, brushed aluminium, grey
 - G - Window infill panels - Dark Blue (Exact RAL to be confirmed)



1 North Elevation
1 : 100



2 East Elevation
1 : 100



3 South Elevation
1 : 100



4 West Elevation
1 : 100

Scale 1 to 100 1 0 1 2 5 Metres

No.	Description	Date	Issued by
A	Issued for PLANNING	22/03/2016	JP

Use figured dimensions only. All levels and dimensions to be checked on site. This drawing is to be read in conjunction with all other relevant drawings and specifications. All rights reserved. Hunters South Architects Limited.

hunters south architects

Sussex Business Village
Lake Lane, Barnham
West Sussex. PO22 0AA
T 01243 558750

info@hunterssoutharchitects
www.hunterssoutharchitects

Project Name:
Emmbrook School

Dwg Reference:
Proposed Elevations

Scale:	As Indicated @ A1	Status:	PLANNING
Date:	March 2016	Checked:	AJ
Job No:	Z0158	Dwg No:	PL006
Drawn:	JP	Rev:	A



Red Brick, Manufacturer TBC

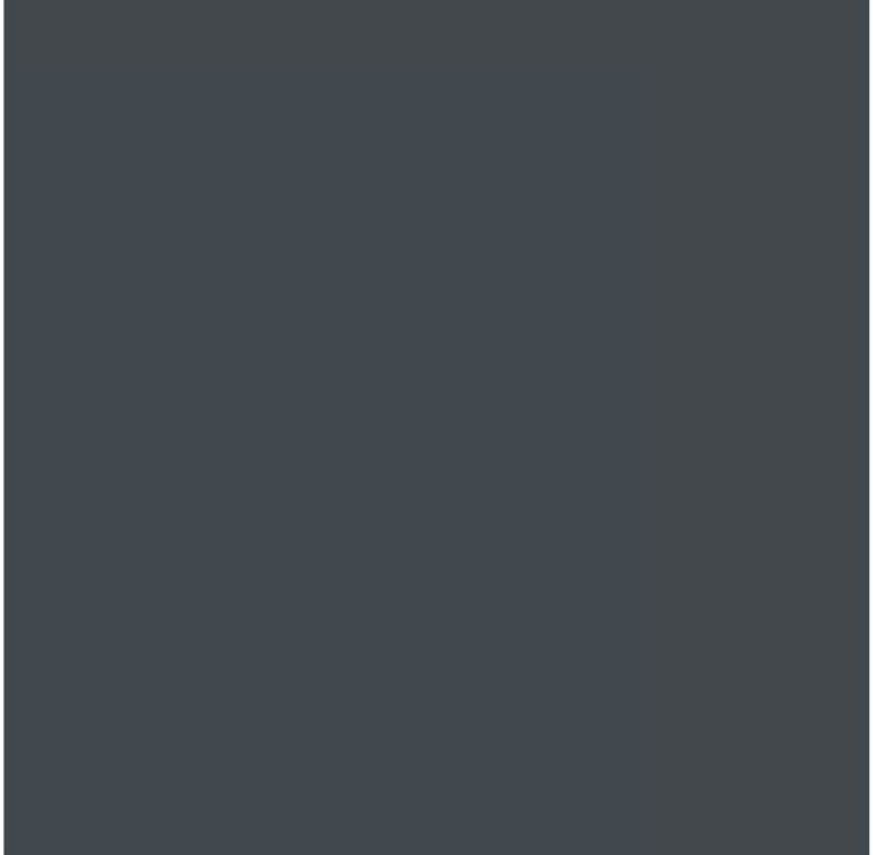

Coping and gutter - dark grey. RAL to be confirmed



Rainscreen Cladding - Trespa Miteon, multi white.



Aluminium windows. RAL to be confirmed



Window Infill Panels. RAL to be confirmed

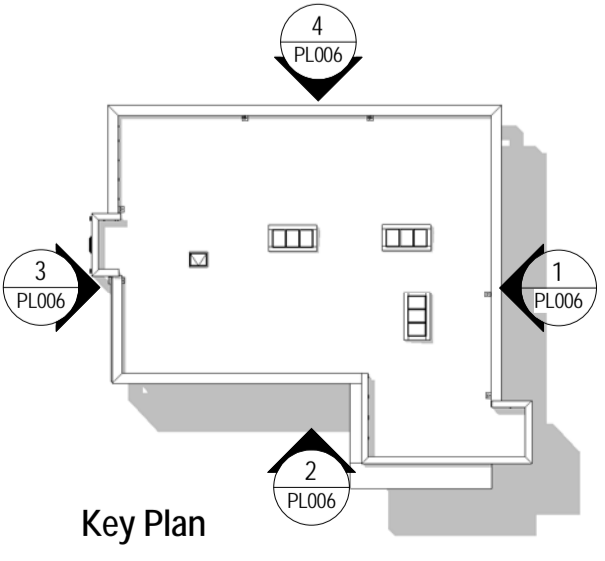

Key Plan

This page is intentionally left blank