

NOTE
 THIS DRAWING IS THE COPYRIGHT OF AMASIA ARCHITECTS LTD AND MAY NOT BE COPIED, ALTERED OR REPRODUCED IN ANY FORM, OR PASSED TO A THIRD PARTY WITHOUT THE WRITTEN CONSENT OF AMASIA ARCHITECTS LTD. DIMENSIONS SHOULD BE CHECKED AND VERIFIED ON SITE AND ANY DISCREPANCIES SHOULD BE REPORTED TO THE ARCHITECT. USE FIGURED DIMENSIONS ONLY. **IF IN DOUBT ASK FOR CONFIRMATION.**

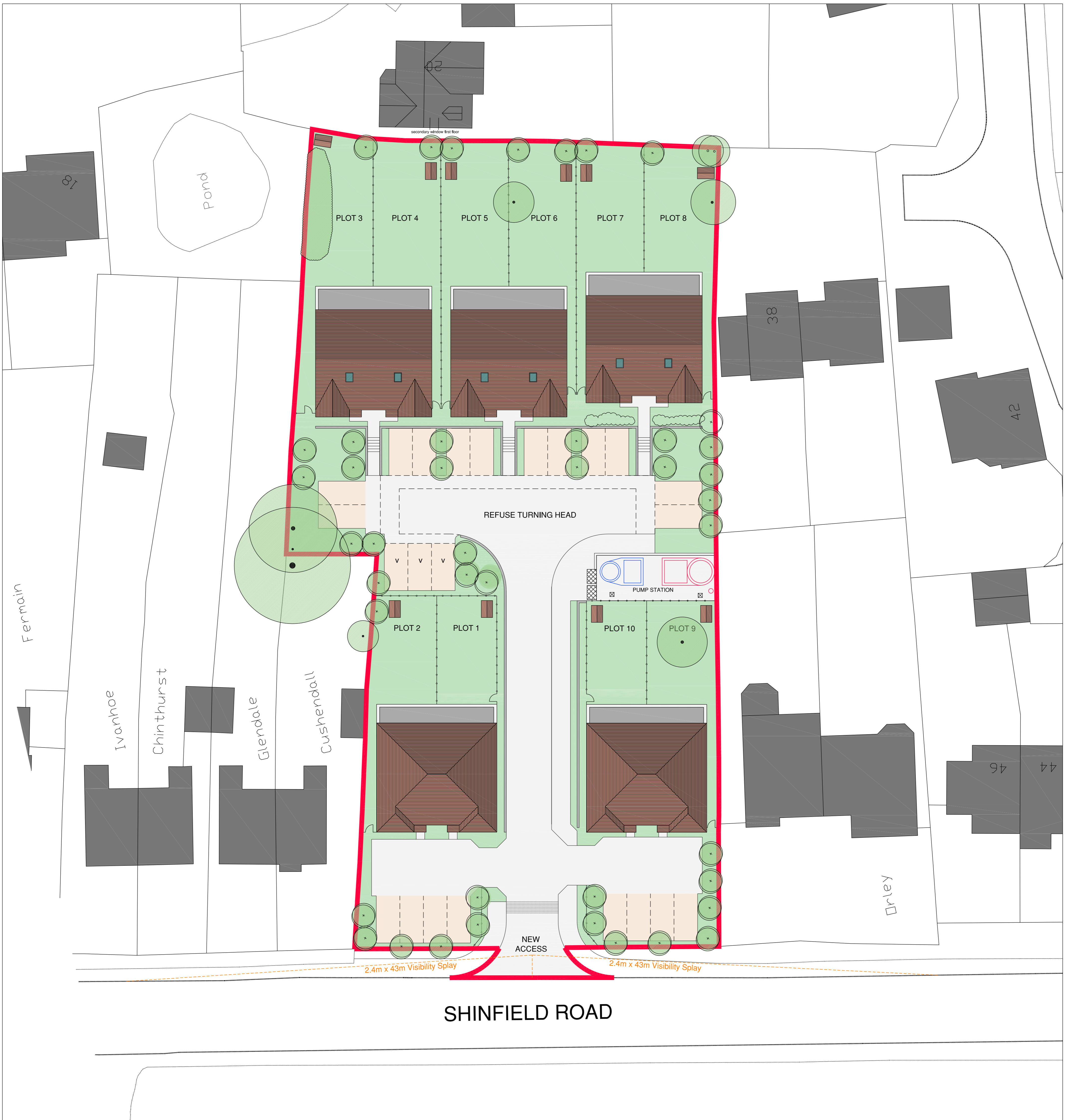

- KEY**
- Existing trees to remain
 - Existing trees to be removed
 - Indicative landscaping
 - Indicative tree planting
 - 1800mm x 1200mm shed for secure cycle storage

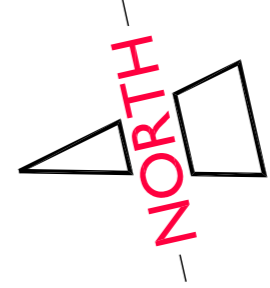

REV.	DESCRIPTION	DRAWN	DATE
A	REVISED TO L.A COMMENTS	SG	05-02-16

REVISIONS			
PROPOSALS			
SITE ADDRESS RUSTLINGS, THE SPRING & LAND R/O CUSHENDALL, SHINFIELD RD, READING, RG2 9BE			
CLIENT ABAVA DEVELOPMENTS			
SCALE	SHEET SIZE	DRAWN	DATE
I-200	A1	SG	08-12-15
DRAWING TITLE SITE LAYOUT			
DRAWING NUMBER AAL-13-147-P01		REVISION A	

ALBURY ESTATE
 LOWER BARN
 WESTON FARM
 ALBURY
 SURREY
 GU5 9BZ
 T: 01483 205724
 www.amasiaarchitects.com
 enquiries@amasiaarchitects.com
 Company Reg. No. 689033
 VAT Reg. No. 946 3191 10

This page is intentionally left blank